

3 degrees of freedom simple robotic arm Makeup instructions

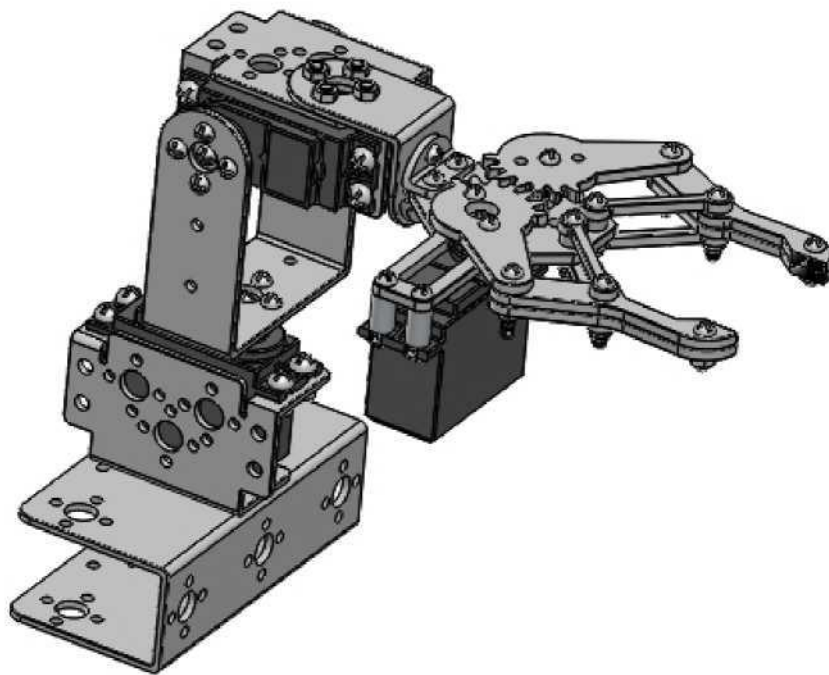

2021(V1.0)

1. Installation of base bracket:
round head M3*7 screw, M3 nut

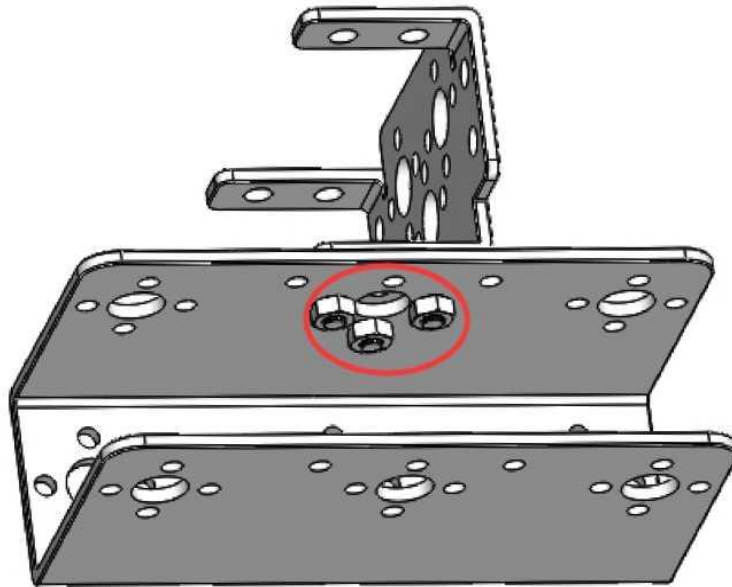
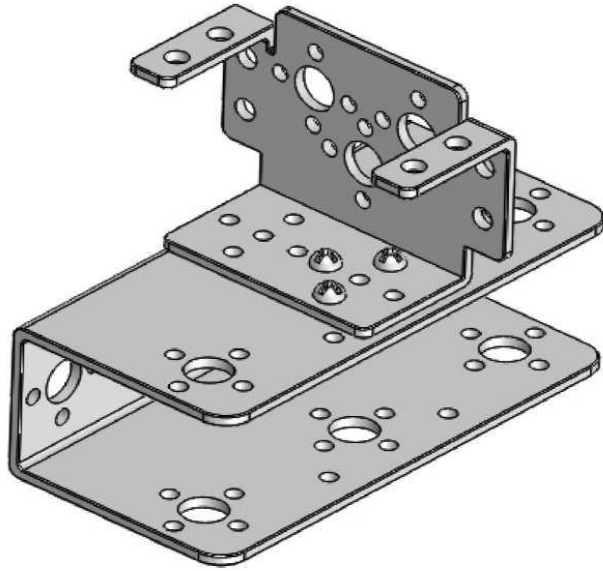

2. Installation of base bracket servo: round head

M4*8 screw, M4 nut

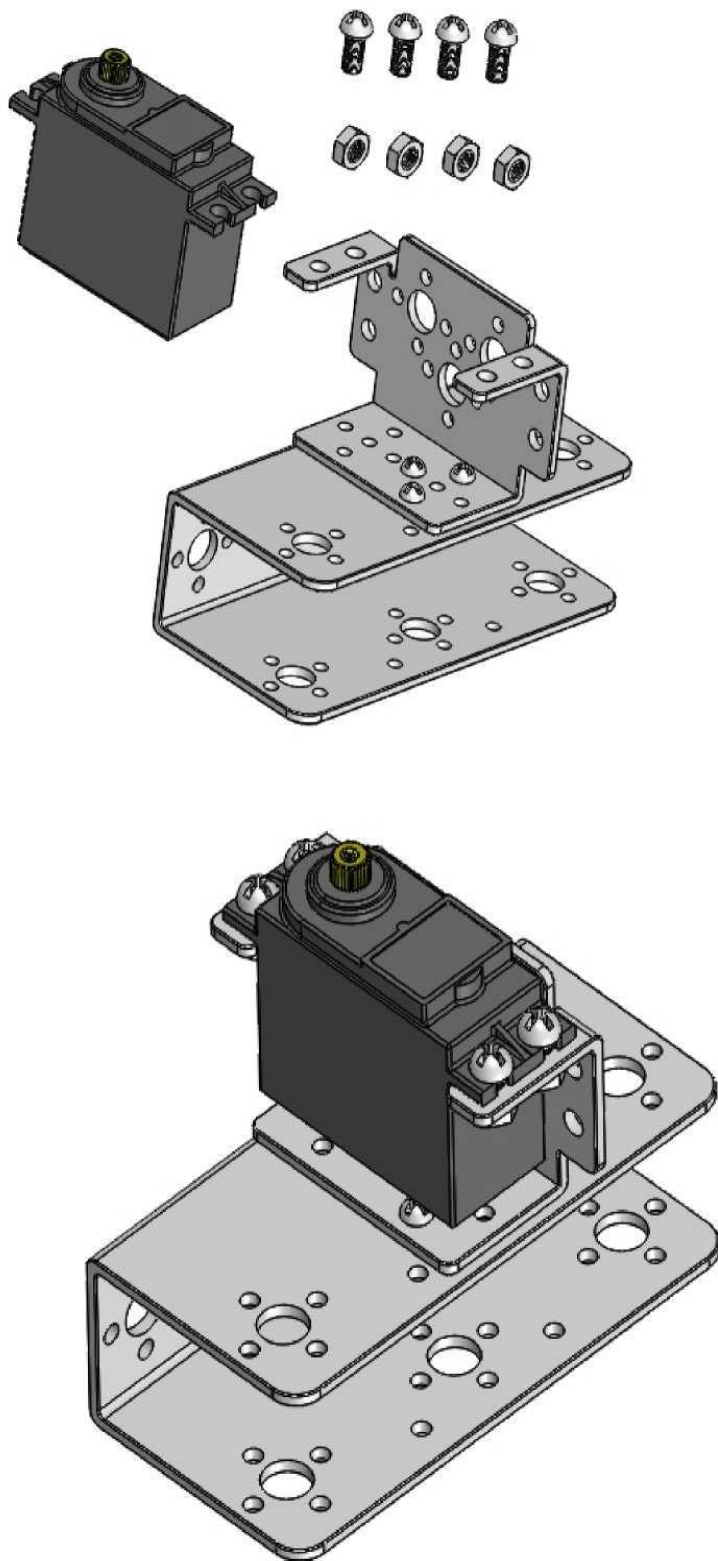

3. Installation of the steering gear of the base bracket:
the metal steering gear, adjust the angle of the steering gear to the middle position (1500) and then install it.

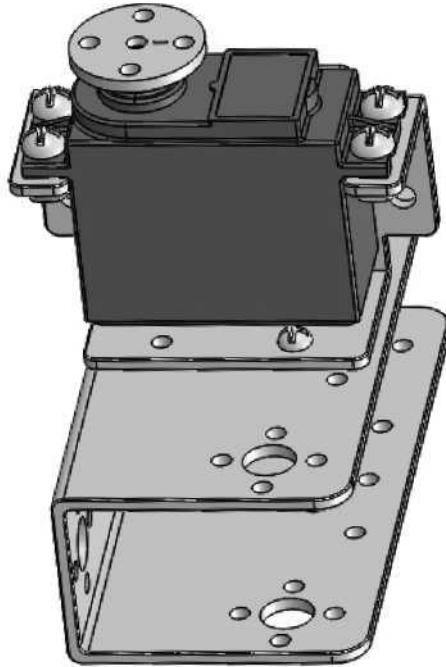

4. The long U-shaped piece of base connection:
long U bracket, round head M3*7 screw, M3 nut

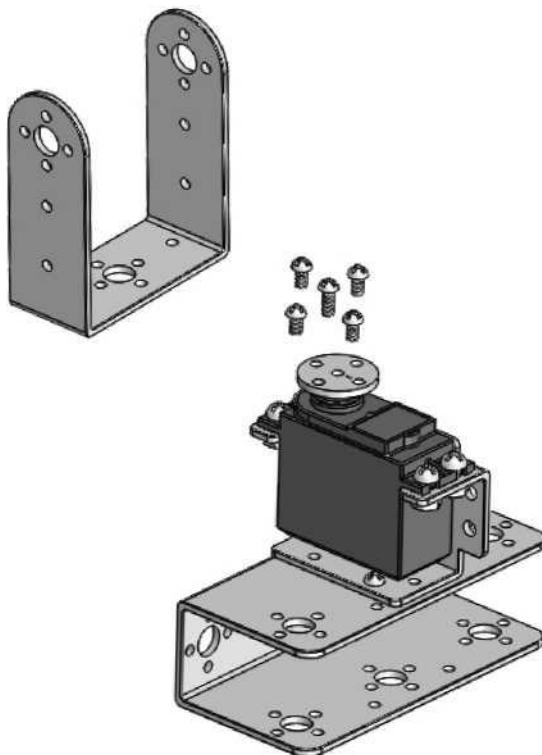

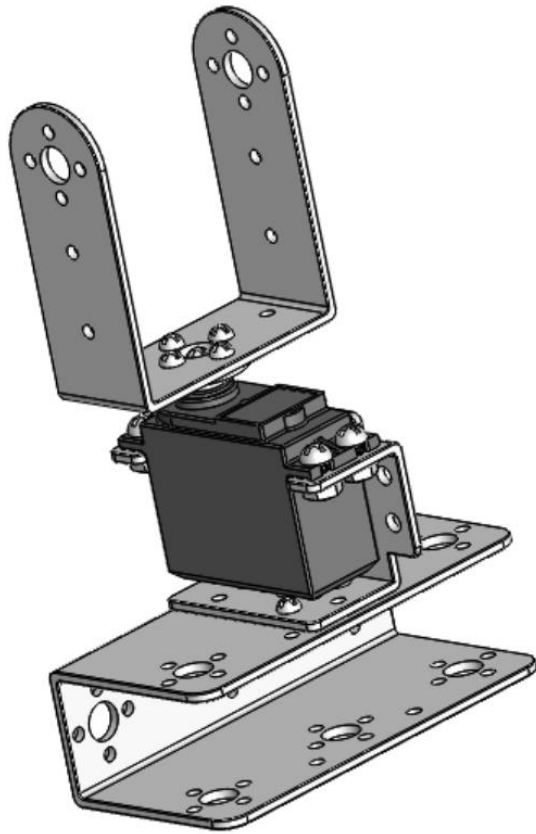

5. Installation of the claw servo: first install the metal rudder disc and round head M3*5 screws

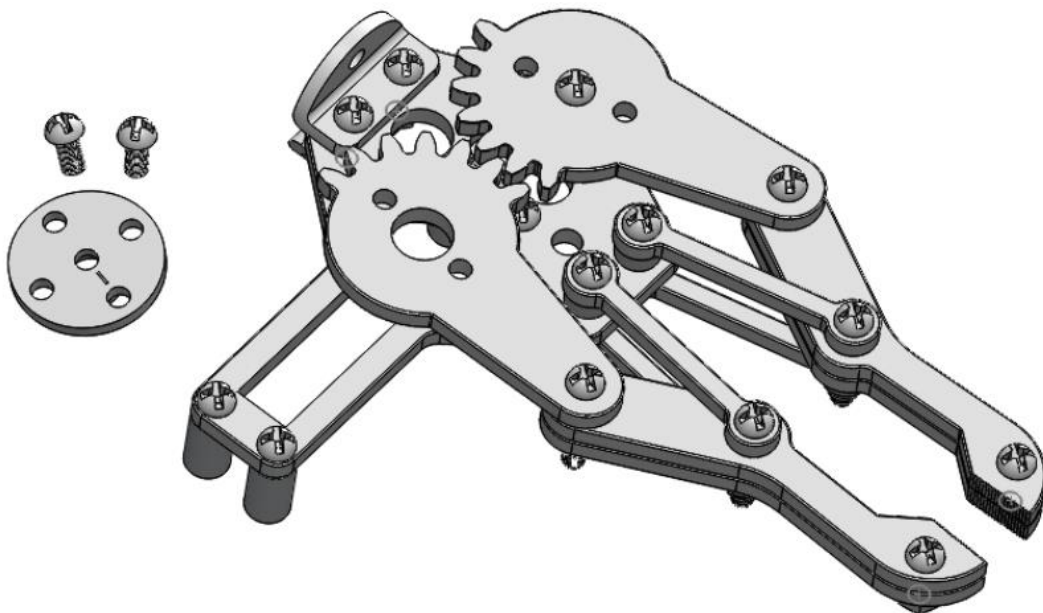

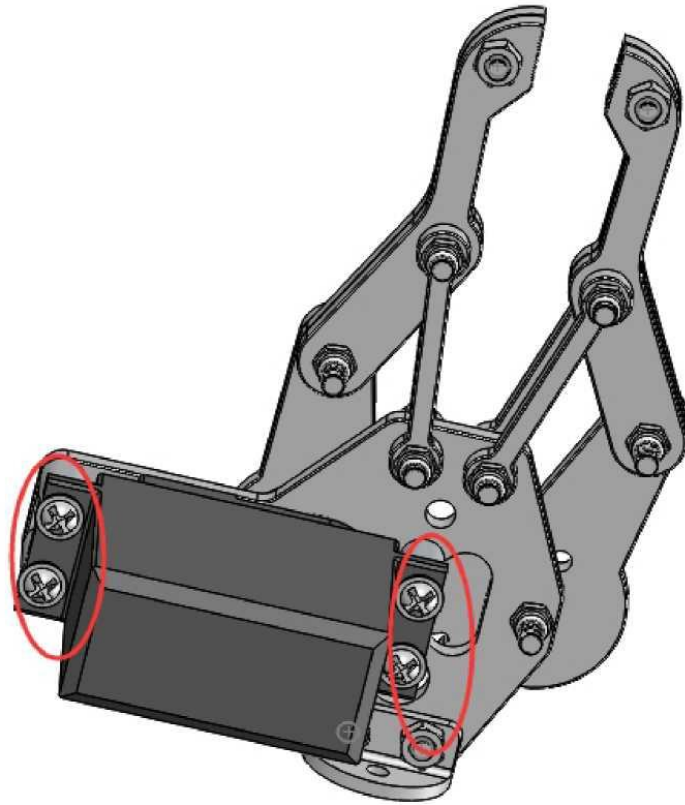

6. Connect the paws to the multifunctional bracket

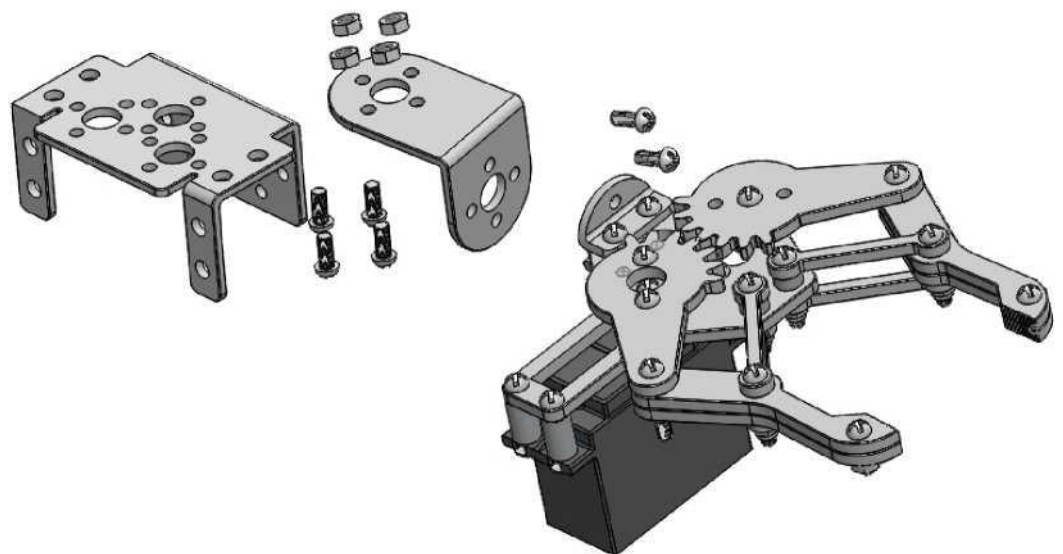

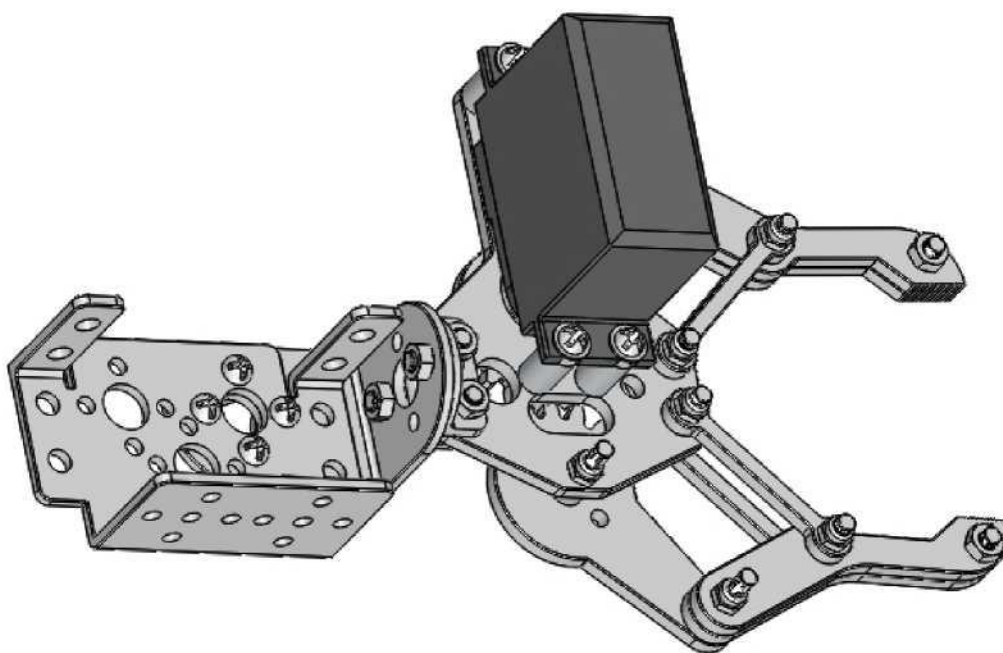
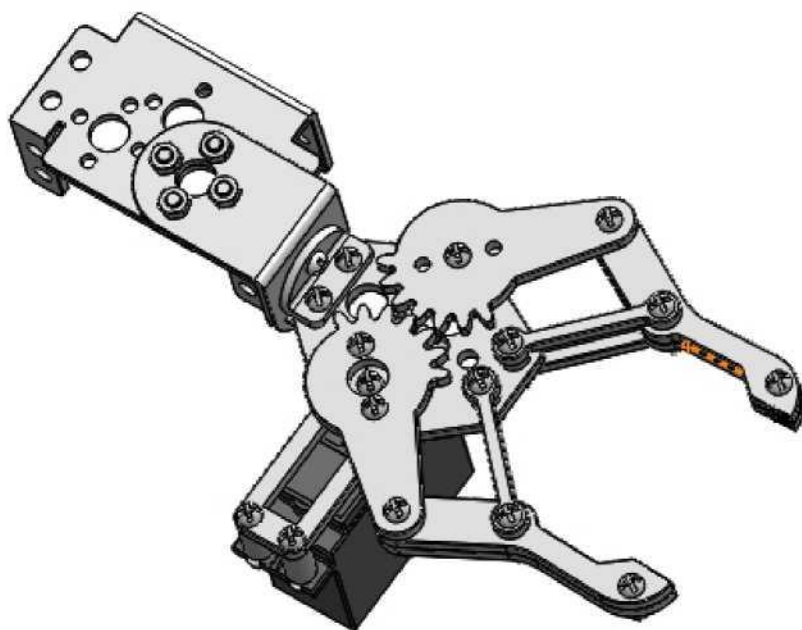

7. Install the servo in the multi-function bracket:
Note that a round-head M3*10 screw needs to be inserted beforehand, and then install the servo.

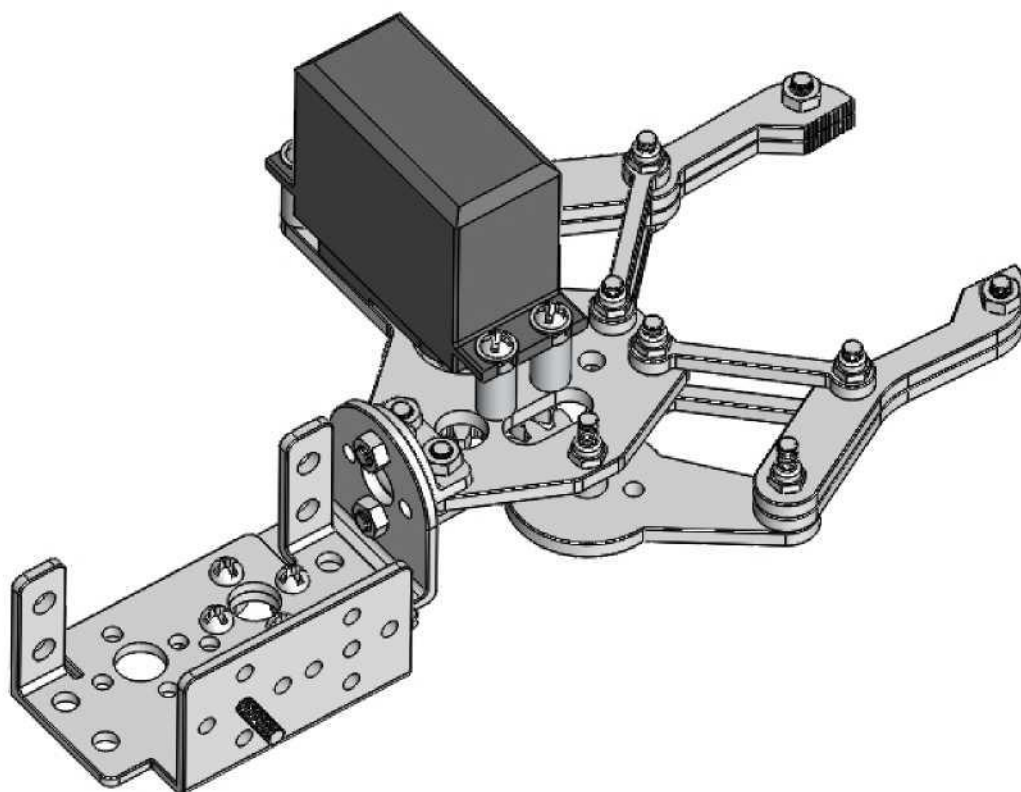
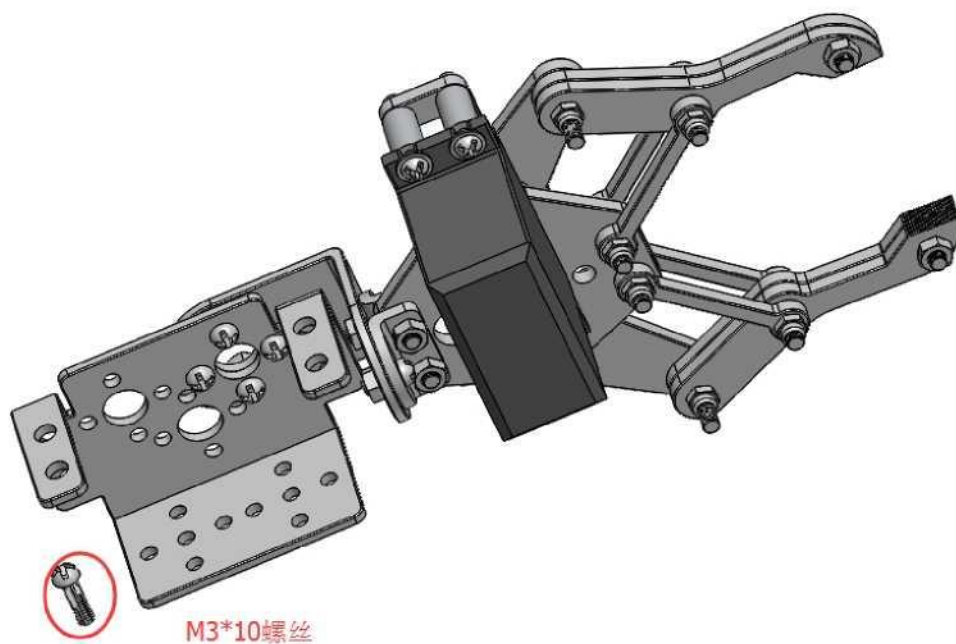

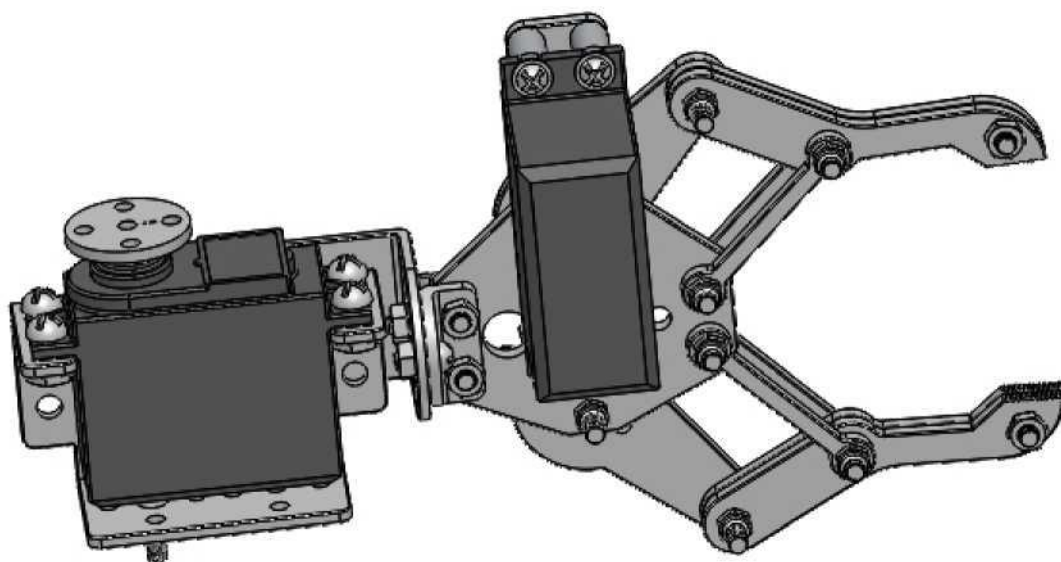
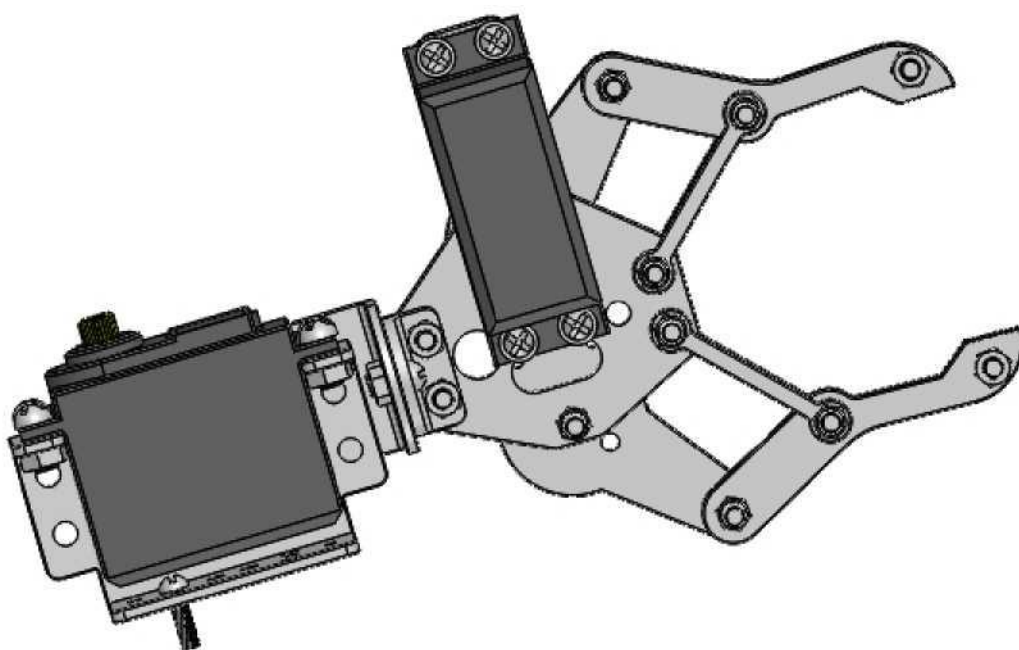
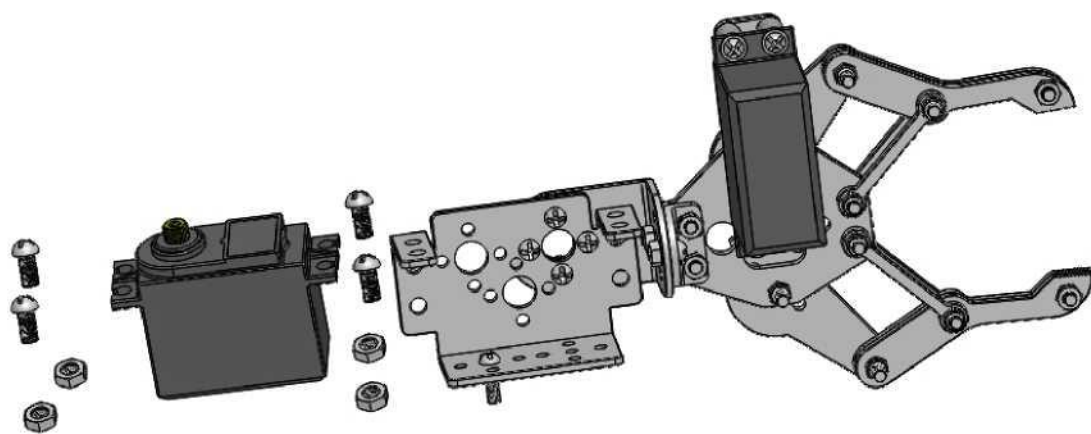

7. Connect the base and the claws:
use metal rudder discs and bearings.

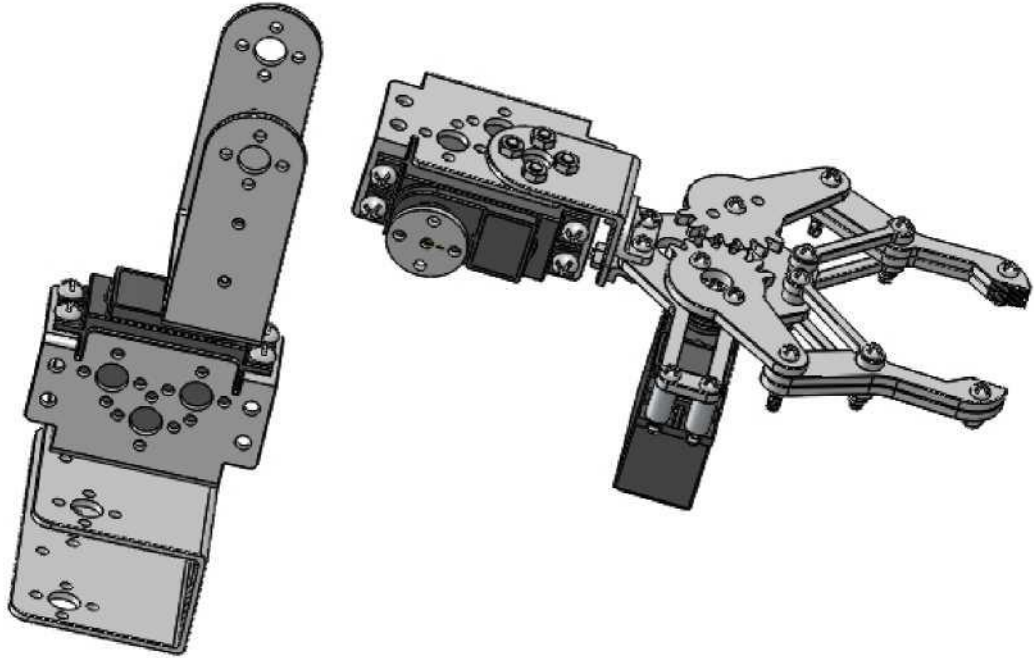

8.

